

Copper Nickel Catalogue

IN
CU

Stirlings
AUSTRALIA

value • quality • service

CuNi Pipe

DIN 86019 / BS 2871 CN102
10 bar & 14 bar
90/10 CuNi

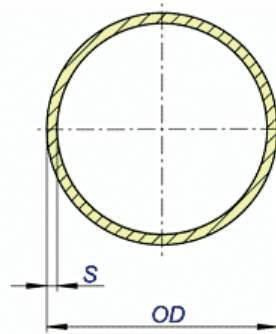

10 bar

inch	Outside diameter of pipe		Wall Thickness		Weight (theoretical) kg/m	Pressure Rating	Availability
	nominal ND	actual mm	actual mm				
0.125		10	1.0	0.26	10		
0.25		12	1.0	0.31	10		
0.38	10	16	1.0	0.42	14	●	
0.5	15	20	1.0	0.53	14	●	
0.75	20	25	1.5	0.99	14	●	
1	25	30	1.5	1.20	10	●	
1.25	32	38	1.5	1.54	10	●	
1.5	40	44.5	1.5	1.81	10	●	
2	50	57	1.5	2.34	10	●	
2.5	65	76.1	2.0	4.16	14	●	
3	80	88.9	2.0	4.88	10	●	
4	100	108	2.5	7.41	14	●	
5	125	133	2.5	9.16	10	●	
6	150	159	2.5	10.99	10	●	
7	175	193.7	2.5	13.43	10		
8	200	219.1	3.0	18.21	10	●	
10	250	267	3.0	22.24	10	●	
12	300	323.9	4.0	35.94	10	●	
14	350	368	4.0	40.9	10		
16	400	419.1	4.0	46.62	10		
18	450	457.2	4.0	50.91	10		
20	500	508	4.5	63.63	10		
24	600	610	5.0	84.96	10		
28	700	711	6.0	118.80	10		
32	800	813	6.0	135.99	10		
36	900	914	8.0	203.57	10		

● Stocked Item ○ Market Available

CuNi Nipples

BSP Thread

90/10 CuNi

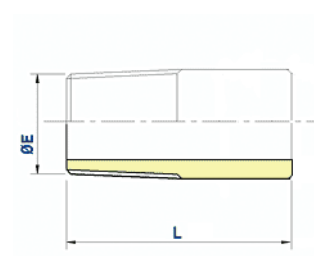
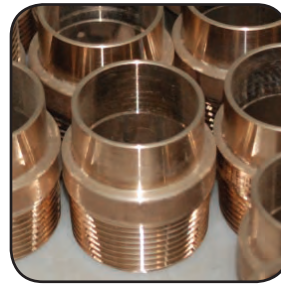

Outside diameter of pipe		ØE Thread (BSP)	L mm	Theoretical Weight Kg/piece	Availability
nominal inch	actual mm				
0.25	12	0.25"	35	0.04	•
0.38	16	0.38"	35	0.04	•
0.5	20	0.5"	35	0.04	•
0.75	25	0.75"	40	0.07	•
1	30	1"	40	0.11	•
1.25	38	1.25"	50	0.14	•
1.5	44.5	1.5"	50	0.21	•
2.0	57	2"	55	0.35	•
2.5	76.1	2.5"	75	0.68	•

CuNi Tees

10 bar & 14 bar
DIN 86088 / EEMUA 146
European Standard
90/10 CuNi

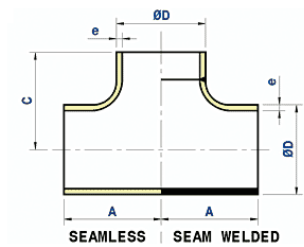

Outside diameter of pipe D		Wall Thickness e mm	A mm	C mm	Theoretical Weight Kg/piece	Availability
nominal inch	actual mm					
0.5	20	1	25	25	0.05	
0.75	25	1.5	29	29	0.07	•
1	30	1.5	38	38	0.10	
1.25	38	1.5	48	48	0.13	•
1.5	44.5	1.5	57	57	0.19	•
2	57	1.5	64	64	0.29	•
2.5	76.1	2	76	76	0.65	•
3	88.9	2	86	86	0.82	•
4	108	2.5	105	105	1.60	
5	133	2.5	121	121	3.10	•
6	159	2.5	143	143	4.40	
7	193.7	2.5	157	157	4.70	
8	219.1	3	178	178	12.8	•
10	267	3	216	216	16.6	
12	323.9	4	254	254	31.5	
14	368	4	279	279	39.4	
16	419.1	4	305	305	55.1	
18	457.2	4	343	343	67.65	
20	508	4.5	381	381	92.8	
24	610	5	432	432	126.6	

CuNi Elbows

DIN 86089
10 bar & 14 bar
90/10 CuNi

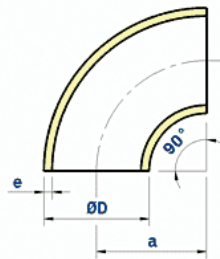

Nominal Inch	Outside diameter of pipe ØD		Wall thickness e mm	Radius a mm	Theoretical Weight kg/piece	Availability
		actual mm				
0.5		20	1	25	0.02	•
0.75		25	1.5	27.5	0.04	•
1		30	1.5	33.5	0.06	•
1.25		38	1.5	45	0.10	•
1.5		44.5	1.5	51	0.14	•
2		57	1.5	72	0.26	•
2.5		76.1	2	95	0.61	•
3		88.9	2	114.5	0.87	•
4		108	2.5	142.5	1.64	•
5		133	2.5	181	2.58	•
6		159	2.5	216	3.70	•
7		193.7	2.5	270	5.65	
8		219.1	3	305	8.66	•
10		267	3	378	13.10	•
12		323.9	4	457	25.61	•
14		368	4	533.5	34.00	
16		419.1	4	609.5	39.40	
18		457.2	4	686	48.40	
20		508	4.5	762	75.62	
24		610	5	915	121.24	

• Stocked Item ○ Market Available

CuNi Reducers

DIN 86089
10 bar & 14 bar
90/10 CuNi

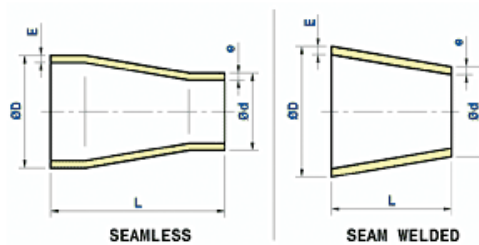

Outside diameter		Wall thickness		Length	Theoretical Weight	Availability
ØD x Ød nominal inch	ØD x Ød actual mm	E mm	e mm	L mm	Kg/piece	
0.5 x 0.38	20 x 16	1	1	30	0.01	
0.75 x 0.38	25 x 16	1.5	1	30	0.02	
0.75 x 0.5	25 x 20	1.5	1	30	0.03	●
1 x 0.38	30 x 16	1.5	1	35	0.03	
1 x 0.5	30 x 20	1.5	1	35	0.04	●
1 x 0.75	30 x 25	1.5	1.5	35	0.05	●
1.25 x 0.38	38 x 16	1.5	1	50	0.05	
1.25 x 0.5	38 x 20	1.5	1	50	0.06	●
1.25 x 0.75	38 x 25	1.5	1.5	50	0.07	●
1.25 x 1	38 x 30	1.5	1.5	50	0.08	●
1.5 x 0.5	44.5 x 20	1.5	1	80	0.09	●
1.5 x 0.75	44.5 x 25	1.5	1.5	80	0.11	●
1.5 x 1	44.5 x 30	1.5	1.5	80	0.12	
1.5 x 1.25	44.5 x 38	1.5	1.5	80	0.13	●
2 x 0.5	57 x 20	1.5	1.5	80	0.14	●
2 x 0.75	57 x 25	1.5	1.5	80	0.14	●
2 x 1	57 x 30	1.5	1.5	80	0.15	●
2 x 1.25	57 x 38	1.5	1.5	80	0.16	●
2 x 1.5	57 x 44.5	1.5	1.5	80	0.24	●
2.5 x 1	76.1 x 30	2	1.5	90	0.25	
2.5 x 1.25	76.1 x 38	2	1.5	90	0.25	●
2.5 x 1.5	76.1 x 44.5	2	1.5	90	0.26	●
2.5 x 2.0	76.1 x 57	2	1.5	90	0.29	●
3 x 1.25	88.9 x 38	2	1.5	90	0.29	
3 x 1.5	88.9 x 44.5	2	1.5	90	0.30	
3 x 2.0	88.9 x 57	2	1.5	90	0.32	●
3 x 2.5	88.9 x 76	2	2	90	0.40	●
4 x 1.5	108 x 44.5	2.5	1.5	100	0.46	
4 x 2	108 x 57	2.5	1.5	100	0.48	
4 x 2.5	108 x 76.1	2.5	2	100	0.57	●
4 x 3	108 x 88.9	2.5	2	100	0.61	●

● Stocked Item ○ Market Available

Outside diameter		Wall thickness		Length	Theoretical Weight	Availability
ØD x Ød nominal inch	ØD x Ød actual mm	E mm	e mm	L mm	Kg/piece	
5 x 2	133 x 57	2.5	1.5	140	0.8	
5 x 2.5	133 x 76.1	2.5	2	140	0.93	
5 x 3	133 x 88.9	2.5	2	140	0.98	
5 x 4	133 x 108	2.5	2.5	140	1.16	•
5 x 2	133 x 57	3	1.5	140	0.86	
5 x 2.5	133 x 76.1	3	2	140	1.06	
5 x 4	133 x 108	3	2.5	140	1.34	
6 x 2.5	159 x 76.1	2.5	2	150	1.13	
6 x 3	159 x 88.9	2.5	2	150	1.19	
6 x 4	159 x 108	2.5	2.5	150	1.38	•
6 x 5	159 x 133	2.5	2.5	150	1.51	•
7 x 3	193.7 x 88.9	2.5	2	155	1.39	
7 x 4	193.7 x 108	2.5	2.5	155	1.58	
7 x 5	193.7 x 133	2.5	2.5	155	1.71	
7 x 6	193.7 x 159	2.5	2.5	155	1.86	
7 x 4	193.7 x 108	3.5	2.5	155	2.21	
8 x 4	219.1 x 108	3	2.5	155	2.47	
8 x 5	219.1 x 133	3	2.5	155	2.6	•
8 x 6	219.1 x 159	3	2.5	155	2.74	•
8 x 7	219.1 x 193.7	3	2.5	155	2.93	
8 x 4	219.1 x 108	3.5	2.5	155	2.88	
10 x 5	267 x 133	3	2.5	210	3.3	
10 x 6	267 x 159	3	2.5	210	3.49	
10 x 7	267 x 193.7	3	2.5	210	3.75	
10 x 8	267 x 219.1	3	3	210	4.25	•
12 x 5	323.9 x 133	4	2.5	210	5.3	
12 x 6	323.9 x 159	4	2.5	210	5.6	
12 x 7	323.9 x 193.7	4	2.5	210	6.02	
12 x 8	323.9 x 219.1	4	3	210	6.3	•
12 x 10	323.9 x 267	4	3	210	6.88	
14 x 6	368 x 159	4	2.5	300	8.75	
14 x 7	368 x 193.7	4	2.5	300	9.34	
14 x 8	368 x 219.1	4	3	300	9.76	
14 x 10	368 x 267	4	3	300	10.57	
14 x 12	368 x 323.9	4	4	300	11.53	
16 x 7	419.1 x 193.7	4	2.5	325	11.04	
16 x 8	419.1 x 219.1	4	3	325	11.5	
16 x 10	419.1 x 267	4	3	300	12.38	
16 x 12	419.1 x 323.9	4	4	300	13.42	
16 x 14	419.1 x 368.1	4	4	300	14.22	
18 x 8	457.2 x 219.1	4	3	350	13.14	
18 x 10	457.2 x 267	4	3	350	14.08	
18 x 12	457.2 x 323.9	4	4	350	15.2	
18 x 14	457.2 x 368	4	4	350	16.06	
18 x 16	457.2 x 419.1	4	4	350	17.07	

CuNi Sockets

Sockets form B

90/10 CuNi
BSP Thread

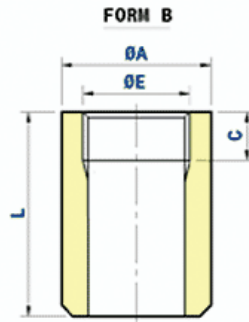

ØD Thread (BSP)	ØA mm	C mm	Form B L mm	Theoretical Weight Kg/piece	Availability
0.25	20	12	20	0.03	•
0.38	25	12	20	0.05	•
0.50	30	14	23	0.08	•
0.50	30	14	50	0.17	
0.50	30	14	75	0.25	
0.50	30	14	100	0.34	
0.50	30	14	125	0.44	
0.75	38	16	25	0.14	•
0.75	38	16	50	0.28	
0.75	38	16	75	0.42	
0.75	38	16	100	0.56	
0.75	38	16	125	0.70	
1	45	18	28	0.19	•
1	45	18	50	0.35	
1	45	18	75	0.52	
1	45	18	100	0.70	
1	45	18	125	0.88	
1.25	55	20	30	0.29	•
1.5	60	22	32	0.37	•
2	75	23	40	0.68	•

• Stocked Item ○ Market Available

CuNi Weld Neck Flanges

Composite weld neck inner flange
 DIN 86037 / EHN9402/150
 10 bar /14 bar
 90/10 CuNi (70/30 available on request)
 Galvanised backing flanges to suit available in stock.

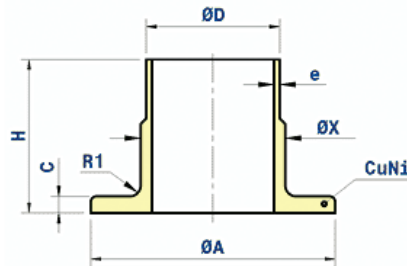

Outside Diametre of pipe ØD		Wall thickness	ØA	H	C	ØX	R1	Theoretical Weight	Availability	
nominal inch	actual mm	e mm	mm	mm	mm	mm	mm	Kg/piece	Spec	
0.5	20	1.5	45	28	5	22	3	0.08	DIN 86037	•
0.75	25	1.5	58	40	5	27	3	0.14	DIN 86037	•
1	30	1.5	68	40	5	32	4	0.24	DIN 86037	•
1.25	38	1.5	78	40	5	40	4	0.26	EHN9402/150	•
1.5	44.5	1.5	88	45	6	46.5	4	0.42	EHN9402/150	•
2	57	1.5	102	45	6	59	5	0.53	EHN9402/150	•
2.5	76.1	2	122	45	6	78	5	0.64	EHN9402/150	•
3	88.9	2	138	50	7	91	5	0.86	EHN9402/150	•
4	108	2.5	158	50	7	110	5	1.10	DIN 86037	•
5	133	2.5	188	50	7	135.5	5	1.50	DIN 86037	•
6	159	2.5	212	50	9	161.5	5	2.00	DIN 86037	•
7	193.7	2.5	242	50	9	197	5	2.30	As Required	
8	219.1	3	268	50	9	222	5	2.70	DIN 86037	•
10	267	3	320	50	9	270	5	3.40	DIN 86037	•
12	323.9	4	370	50	11	327	7	4.60	DIN 86037	•
14	368	4	430	50	11	371	7	6.20	As Required	
16	419.1	4	482	50	12	422	7	7.50	As Required	
18	457.2	4	530	50	12	460	7	9.00	As Required	
20	508	4.5	585	50	12	511	7	10.65	As Required	
24	610	5	685	60	14	613	9	14.90	As Required	

Galvanised backing flanges to suit available in stock.

• Stocked Item ○ Market Available

Galvanised Backing Flanges

Mild Steel Galvanised
Manufactured to Table D/E AS250
Suitable for composite weld neck flanges.
Din 86037



Size Pipe NB/ Tube (mm)	Overall Diameter (mm)	Internal Diameter (mm)	PCD	Thickness	Hole Diameter	Number of Holes	Approximate Weight (Kg)	Availability
20 / 25	102	33	73	12	14	4	0.67	●
25 / 30	114	40	83	12	14	4	0.85	●
32 / 38	121	48	87	12	14	4	0.90	●
40 / 44.5	133	54.5	98	12	14	4	1.13	●
50 / 57	152	69	114	12	17.5	4	1.44	●
65 / 76	165	88	127	12	17.5	4	1.51	●
80 / 89	184	101	146	12	17.5	4	1.97	●
100 / 108	216	120	178	13	17.5	8	2.54	●
125 / 133	254	145.5	210	14	17.5	8	2.58	●
150 / 159	279	171.5	235	17	22	8	4.39	●
200 / 219	337	232	292	19	22	8	7.39	●
250 / 267	406	280	356	22	22	12	11.57	○
300 / 324	457	341	406	25	26	12	14.37	●

● Stocked Item ○ Market Available